

**MATERIAL**

Zinc-plated steel, class 5.8 (tensile strength 500 N/mm²).

FEATURES AND APPLICATIONS

GN 346 thrust pads are normally used to transmit clamping forces. They can be adapted on irregular or non-parallel surfaces and allow the clamping preventing the rotating movement of the screw from being exerted directly on the piece to be locked.

TECHNICAL DATA

The values of max limit static load shown in the table were obtained through a series of laboratory tests with vertical static load.

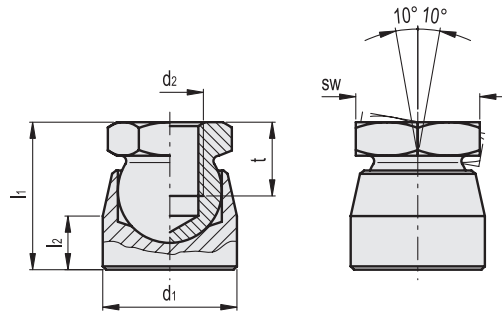

Code	Description	d1	d2	l1	l2	sw	tmin	Max. limit static load [N]	
GN.11983	GN 346-16-M8	16	M8	19	7	12	9	5000	20
GN.11985	GN 346-20-M10	20	M10	22	8	15	11	7500	35
GN.11987	GN 346-24-M12	24	M12	25	10	17	12	10000	55
GN.11989	GN 346-30-M16	30	M16	34	13	24	16	15000	115